

Whist every attempt has been made to ensure the accuracy of the floor plan contained here, measurements of doors, windows, rooms and any other items are approximate and no responsibility is taken for any error, omission, or mis-statement. This plan is for illustrative purposes only and should be used as such by any prospective purchaser. The services, systems and appliances shown have not been tested and no guarantee as to their operability or efficiency can be given.

Made with Metropix ©2017

TOTAL APPROX. FLOOR AREA 667 SQ.FT. (62.0 SQ.M.)

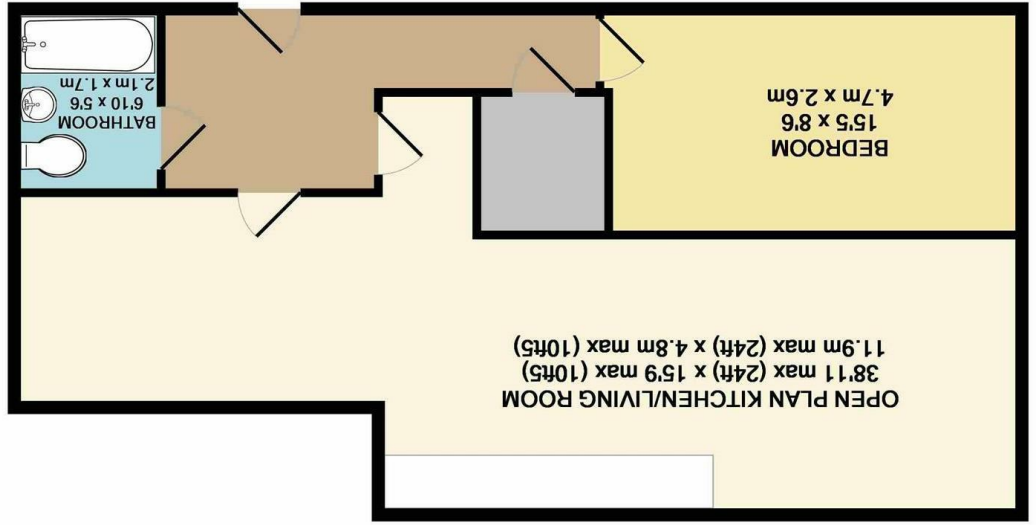

Disclaimer - In accordance with the Property Misdescriptions Act, the company gives notice that all descriptions, references to condition, necessary permissions for use and other details are given in good faith and believed to be correct, but any intending lessees do not rely on them as statements of fact, but must satisfy themselves by inspection or other means, as to their accuracy.

Energy Efficiency Rating	
Current	Potential
65	65
England & Wales EU Directive 2002/91/EC	
Very energy efficient - lower running costs (92 plus) A	
(81-91) B	
(69-80) C	
(55-68) D	
(39-54) E	
(21-38) F	
(1-20) G	
Not energy efficient - higher running costs	



Ber Street | Norwich | NR1
Guide price £160,000

**Norfolk Property
online.**

Norfolk Property Online presents this stylish city centre apartment. One of the largest one-bedroom apartments within the development, this property offers generous living accommodation to complement the spacious bedroom. Finished to a high standard throughout, this offers an ideal opportunity for any buyer looking to enjoy the convenience of city living or as an investment opportunity. An internal viewing comes highly recommended.

Guide price £160,000-£170,000

Tax Band - B

